

SD-782Bicycle Recharge Taillight Instructions

Functions

- 5 Flash Modes: Water Flash/Chasing Flash/Breathing Flash/Warning Flash/Exposure Flash
- Long Flash Function
- Automatic Flash Function
- Rechargeable Battery
- Waterproof Design

Parts List

① Rubber Strap

② Host

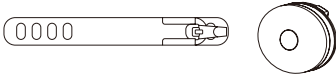

Parts INFO

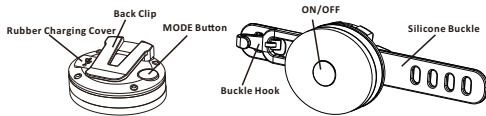

Battery Charging

Open the rubber charging cover, insert the plug into the socket, Port □ Micro □ USB, Charging voltage 4.5V

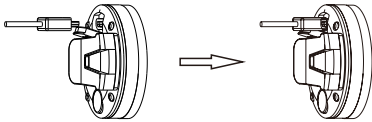

The red light next to the button lights during charging, and the red light goes out after about 4 hours. When the green light is on, the battery is fully charged and the charging is complete.

After the battery is fully charged, different modes can work continuously: Water flash 12 hours, Chasing flash 15 hours, Breathing flash 7 hours, Warning flash 8 hours, Exposure flash 51 hours, when the battery power is low, the LED light stops flashing and automatically enters the shutdown state.

Installation

Install on the backpack:

Use the back clip on the host back to clip the host to the backpack (as shown below)

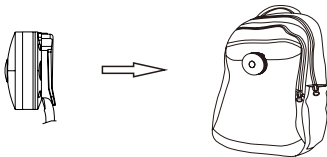

Install on seatpost and handlebar:

Push the buckle belt into the back clip of the host (as shown below), pay attention to the direction of the buckle, with a sloped upward.

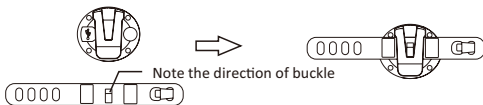

Attach the installed buckle belt of the host to the seatpost or handlebar:

Attach the buckle belt close to the seatpost or handlebar, tighten the buckle belt to hang the hook into the round hole, and pin the end of the buckle belt into the bottom of the hook (As shown below)

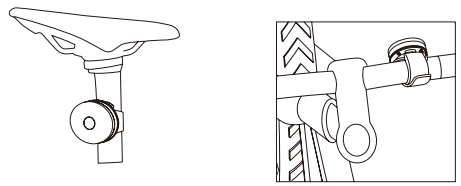
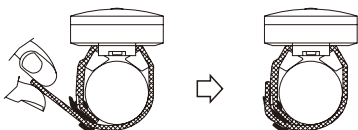

Operating Instruction

Long Open Function:

Press ON/OFF key, the tail light will enter the long open function state, and the LED light will be flashing in the mode of water flash. In the long open function state, press the MODE key to switch to chasing flash, breathing flash, warning flash, and exposure flash mode in turn.

Automatic Flash Function:

In the long open function state, press the ON/OFF button to flash the LED light fully twice before entering the automatic flashing function state.

In the automatic flashing state, when the tail light is in a dim light environment, when riding or the taillight is shaken, the LED light starts to blink, and after 20 seconds, if the taillight is at rest or in a bright light environment, the LED light stops flashing.

In the automatic flashing state, press the MODE key to switch to chasing flash, breathing flash, warning flash, and exposure flash mode in turn.

Flash Off:

In the automatic flashing state, press the ON/OFF button to flash the LED light fully once, Flash off.

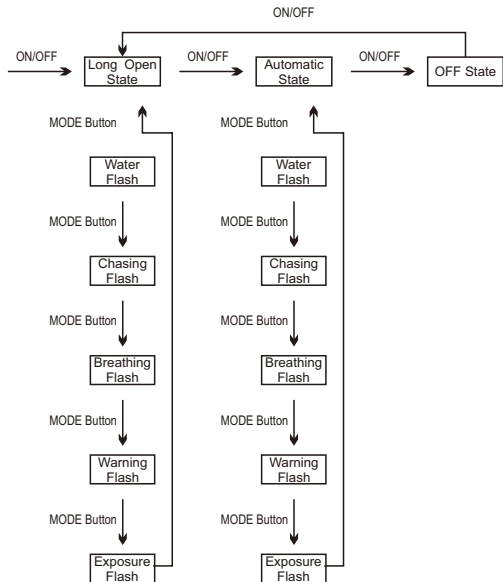

TROUBLESHOOTING

Error	Causes & Troubleshooting
Turn off automatically after the flash light for 1 minute	The battery power is low and needs to be charged
There is abnormal sound when shaking	The sensor scroll switch with automatic function makes a sound, It is normal.