

Connection method

1. Download the Joycune APP iPhone OS and search Lite sports in the Apple Store to select Lite version and click Download. Android version may search it in the 360, Mi, and Huawei apps, and download Lite sports.
2. Click the Joycune sports icon to enter the registration page, log in it with the mobile phone or QQ or WeChat.
3. After successful login, click the "My" menu in the lower right corner, and click the device icon in the "My" menu to enter the Device Add page.
4. On the Device Add page, click Scanning Device under the smart code table.
5. Long press SET+MODE button for 3 seconds in any interface of code table to enter the mobile phone connection page, and then long press the right button for 3 seconds to start connecting to the phone.
6. After the mobile phone connection is successful, the view data is appeared in the APP smart code table. Click the code table name, and the parameter setting pops up at the bottom.
7. Click the parameter setting to enter the code table parameter setting page to set all parameters and functions of code table. The time and date adopts the default value of mobile phone. After the setting is completed, click "Complete Write-in" in the upper right corner to change the data of code table.

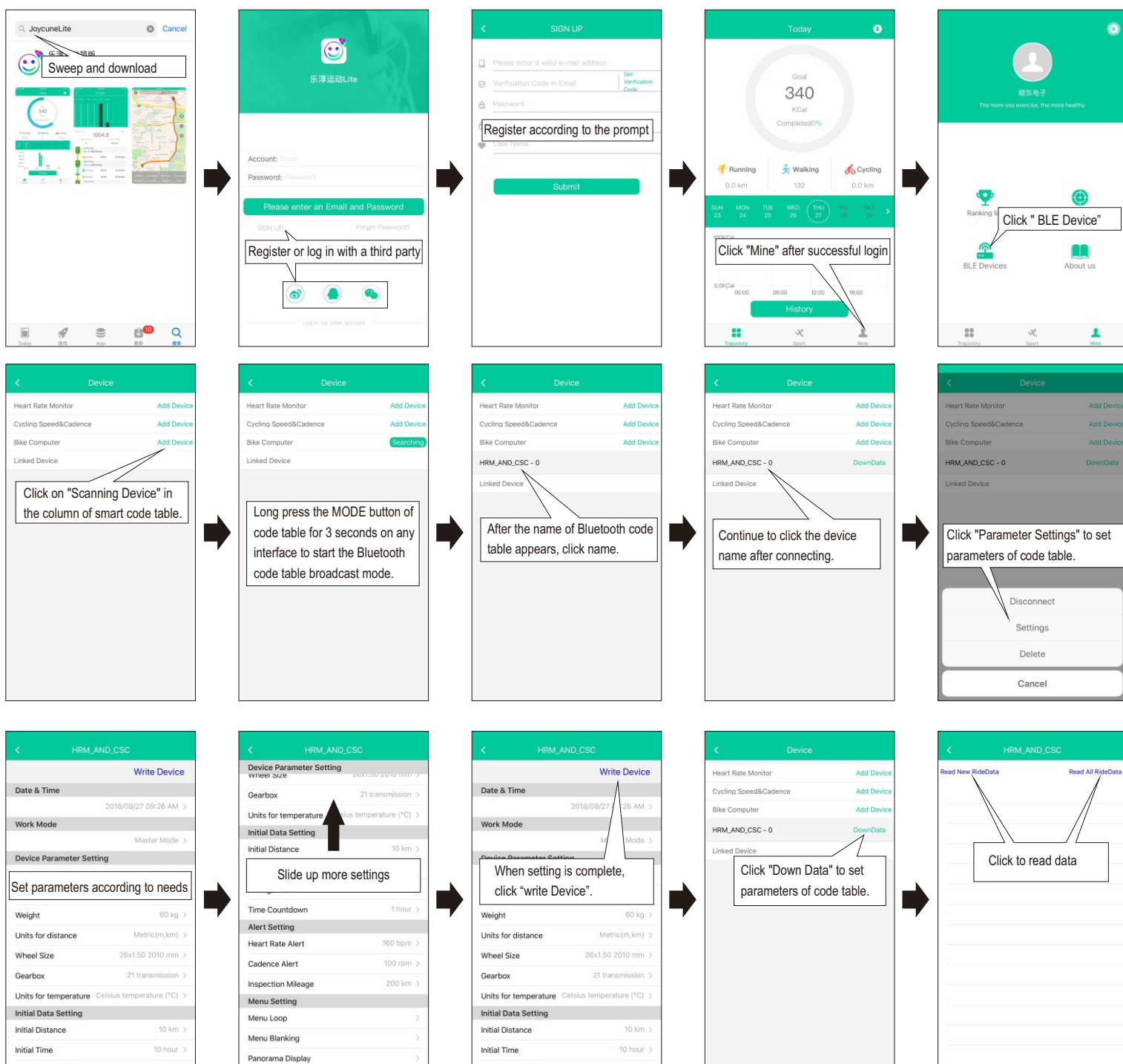

Set parameter description

Date and time

The time and date adopts the current default of mobile phone.

Operating mode

The operating mode is divided into main mode and slave mode.

Main mode: The code table is connected to the main equipment and the accessories, and the riding data is uploaded to mobile phone after collection.

Slave mode: Mobile phone and accessories are connected. The motion data generated by the code table GPS and accessories are transmitted to the code table and displayed on the screen. As the slave unit of mobile phone, the code table only performs the display function, and does not participate in other motion data collection outside of total mileage and total time.

Code table parameter setting

Language

Click the language menu to pop up menu to select Chinese, English, German, French, Italian, Spanish, Swiss and Dutch.

Weight unit

Click the weight unit to pop up menu to select the kg/lb unit.

Weight unit

Click the weight to pop up menu to set the value of body weight. The weight is 65kg in default, and the setting range is 0-299kg.

Wheel circumference unit

Click the wheel circumference unit to pop up menu for setting.

Wheel circumference

Click the wheel circumference to pop up menu to set the wheel circumference, and select the required circumference according to the bicycle tire model and comparison table. Setting range is: 0000mm~4999mm.

Transmission

Set the bicycle's transmission parameters according to the riding. The code table will calculate the gear ratio and recommend parameters of chain wheel and free wheel according to riding speed and the cadence.

Temperature unit

Click the temperature unit to pop up menu to select the Celsius/Fahrenheit unit.

Initial Value Set

Initial distance

Click the initial distance to pop up menu to set the initial distance, and the setting range is 0~99999 km/mile.

Initial Time

Click the initial time to pop up menu to set the initial time, and the setting range is 0~99999 hrs.

Distance Countdown Setting

Click the mileage countdown to pop up menu to set the mileage countdown. The setting range is 0~999.99km/mile.

Time Countdown Setting

Click the time countdown line to pop up menu to set the time countdown, and the setting range is 0~99:59 hours.

Excess-value alarm setting

Excessive heart rate alarm

Set a heart rate maximum value when the heart rate exceeds the maximum value. The heart symbol flickers to prevent the heart from being damaged by a high heart rate.

Excessive cadence alarm

The optimum cadence is 75~95/min. When a maximum value is set, the cadence symbol flashes and jumps after the current cadence exceeds the setting value.

Maintenance Distance

Click the vehicle inspection mileage to pop up menu to set the vehicle inspection mileage. The default value of vehicle inspection mileage is 200, and the setting range is 200~899KM.

Menu

Menu Cycle

Click the menu cycle to pop up menu to set the menu cycle. All functions can be set to join or exit the cycle mode. The menu that is added to cycle mode can cycle and display in 4s, and blanked menus must be blanked before they can be added to cycle mode.

Menu Hidden

Click the menu blanking to pop up menu to set the menu blanking. According to use condition, undesired menus can be blanked. The blanked menu does not display, but the data from the riding will be recorded in the background. The first page of panoramic display cannot be blanked.

Panoramic Display

Panoramic Display Mode allows for the selection of up to three different functions to be displayed concurrently on the screen. First function is displayed by default, while second and third are hidden by default.